



INSTALLATION & MAINTENANCE MANUAL

**NH023AW / NH023B**  
**NH025AW**

## GENERAL INSTRUCTIONS

**These instructions should be read carefully and retained after installation by the end user for future reference and maintenance.**

**These instructions should be used to aid installation of the following products:  
NH023AW / NH023B / NH025AW**

## SAFETY

- This product must be installed in accordance with the latest edition of the IEE Wiring Regulations (BS7671) and current Building Regulations. If in any doubt, consult a qualified electrician
- Please isolate mains prior to installation or maintenance
- Check the total load on the circuit (including when this luminaire is fitted) does not exceed the rating of the circuit cable, fuse, or circuit breaker
- Please note the IP (Ingress Protection) rating of this product when deciding the location for installation
- This product is for indoor use only
- This product is Class I and must be earthed
- This product is IP20 rated

## INSTALLATION

Note - If this luminaire is being used in conjunction with an external PIR or sensor, please confirm with the manufacturer of the sensors that they are compatible with LED luminaires.

- Provide power to the required point of installation
- Remove the front plate by placing a medium size flat-head screwdriver in the notch on the side and lever off gently (see Fig. 1)

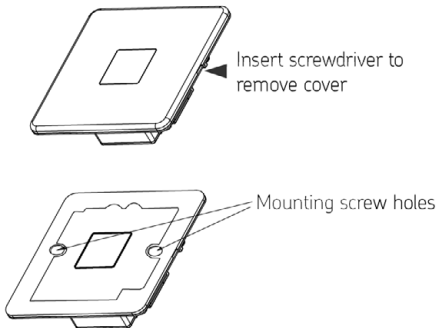

**Fig. 1**

- Connect the luminaire to the mains supply ensuring the correct polarity is observed:  
L – Live (brown), E – Earth (green/yellow), N – Neutral (blue)
- All earth connections must be made and maintained. Use green/yellow sleeving on earth conductors that are not insulated
- Check all electrical connections are secure with no loose strands of cable
- Fit the unit into a suitable wall box taking care not to compress, damage, or trap any cables, and secure with the screws provided
- Clip the front plate onto the main assembly ensuring the screwdriver notch is at the side
- Switch on and check for correct operation

## **WARNING**

This product must be disconnected from the circuit if subjected to any high voltage or insulation resistance testing. Irreparable damage will occur if this instruction is not followed.

## GENERAL

- This product contains a light source of energy efficiency class G (NH023AW, NH025AW) to Regulation (EU) No. 2019/2015 and (UK) 2021 No. 1095.
- This product contains a nonreplaceable LED light source and a nonreplaceable control gear

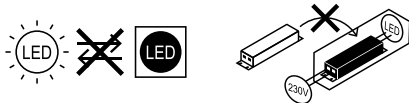

- Clean with a soft dry cloth only, do not use aggressive cleaning products or solvents which may damage the product.
- This product is nondimmable.
- This product should be dismantled for disposal when it reaches the end of its life. Please see website for dismantling instructions.
- This product should be recycled in the correct manner when it reaches the end of its life. Check local authorities for where facilities exist.

## WARRANTY

This product has a warranty of 1 year from date of purchase. Failure to install this product in accordance with the current edition of the IEE Wiring Regulations (BS7671), improper use, or removal of the batch code will invalidate the warranty. If this product should fail within its warranty period, it should be returned to the place of purchase for a free of charge replacement. ML Accessories does not accept responsibility for any installation costs associated with the replacement product. Your statutory rights are not affected. ML Accessories reserve the right to alter product specification without prior notice.



ML Accessories Limited LU5 4LT  
[www.mlaccessories.co.uk](http://www.mlaccessories.co.uk)